

**Parts needed to mount the KRAV-56 extrusion**



Extrusion (A and B)



End cap (C)



LED strip (E)

**WARNING!** All LED strips should be connected to a 12 V or 24 V power supply.

**IMPORTANT:** The mounting instructions present the basic form of assembly. More methods and related accessories can be found at [www.KlusDesign.eu](http://www.KlusDesign.eu)

**1.** Mount the LED strip (E) in the upper part of the extrusion (B) and lead out the power cable.

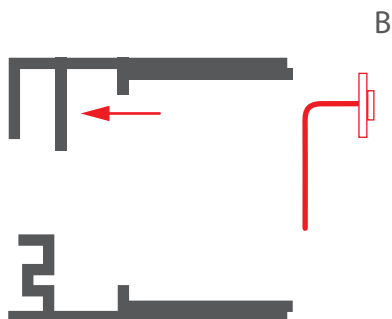

**3.** Degrease the glass and attach the upper part of the extrusion (B).

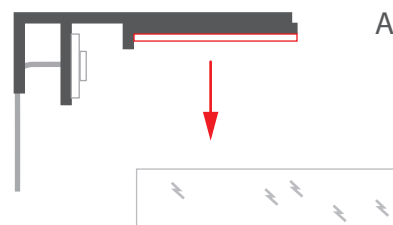

**4.** Attach the lower part of the extrusion (B).

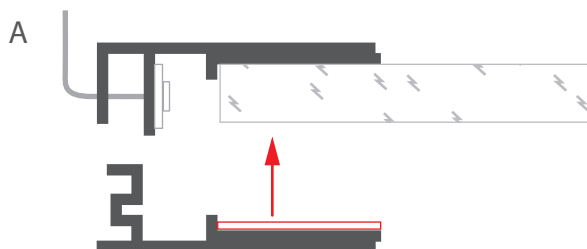

**5.** Insert the end caps (C).

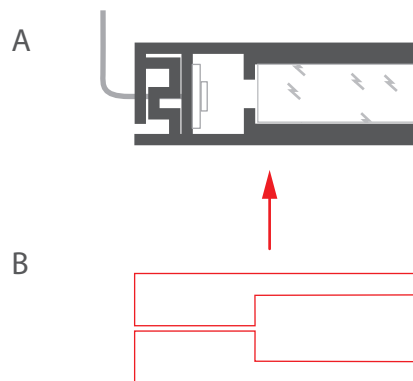

**6.** Connect power.

